

## AeroCentre

**LEED Silver**

250,000 sq. ft. of Access Flooring complete with Underfloor Air.



## Honda

**LEED Gold**

100,000 sq. ft. of Access Flooring complete with Underfloor Air and Modular Wiring



## Accenture

**LEED Silver**

47,000 sq. ft. of Access Flooring complete with Underfloor Air and Modular Wiring



## Manitoba Hydro

**LEED Gold**

**CTBOH Award for 2009's Best Tall Building in the Americas.**

500,000 sq. ft. of Access Flooring complete with Underfloor Air and Modular Wiring



## BMW

**LEED Silver**

60,000 sq. ft. of Access Flooring complete with Underfloor Air and Modular Wiring



## Power Stream

**LEED Gold**

100,000 sq. ft. of Access Flooring complete with Underfloor Air and Modular Wiring

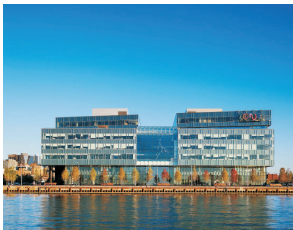

## Corus Waterfront Project

**LEED Gold**

43,000 sq. ft. of Access Flooring

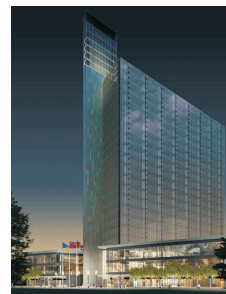

## Pricewaterhouse Coopers

**LEED Gold**

600,000 sq. ft. of Access Flooring complete with Underfloor Air. Multi-Tenant Building.



## Electronic Arts Phase I and II

**LEED Silver**

240,000 sq. ft. of Access Flooring complete with Underfloor Air



## Region of Niagara

**LEED Certified**

100,000 sq. ft. of Access Flooring complete with Underfloor Air and Modular Wiring

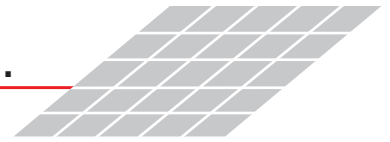

## SAS

**LEED Silver**

120,000 sq. ft. of Access Flooring complete with Underfloor Air. Multi-Tenant Building.



## Taylor Family Digital Library

**LEED Silver**

200,000 sq. ft. of Access Flooring complete with Underfloor Air



## Smart Technologies

**LEED Gold**

186,000 sq. ft. of Access Flooring complete with Underfloor Air



## Telus Ottawa

**LEED Silver**

100,000 sq. ft. of Access Flooring complete with Underfloor Air. Multi-Tenant Building.



## Smith Carter

**LEED Platinum**

25,000 sq. ft. of Access Flooring complete with Underfloor Air



## Union Tower Anchor Tenant Telus

**LEED Silver**

700,000 sq. ft. of Access Flooring complete with Underfloor Air and Modular Wiring. Multi-Tenant Building.



## St. Gabriels Parish

**LEED Gold**

12,000 sq. ft. of Access Flooring complete with Underfloor Air



## Toronto Federal Judicial Centre

**LEED Silver**

35,000 sq. ft. of Access Flooring

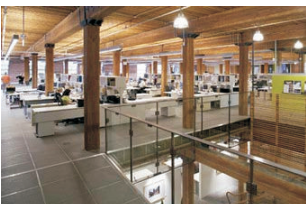

## Stantec

**LEED Gold**

23,000 sq. ft. of Access Flooring complete with Underfloor Air and Modular Wiring.



## Trillium Health Centre

**LEED Silver**

100,000 sq. ft. of Access Flooring complete with Underfloor Air

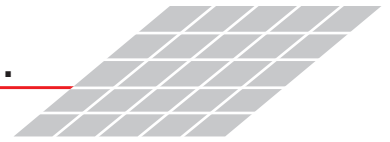

## Vaughan Civic Centre

**LEED Gold**

210,000 sq. ft. of Access Flooring  
complete with Underfloor Air  
and Modular Wiring