

Camino Modular Systems Inc. established in 1970 is an international supplier of access floor systems.

Head Office and Factory

89 Carlingview Drive
Toronto, Ontario, Canada
M9W 5E4
Tel: 416-675-2400 / 1-800-370-0226
Fax: 416-675-2424 / 1-866-370-0226

Mid West Regional Sales Office

Chicago, IL
Tel: 847-427-1800
Fax: 847-427-8173

Southern Regional Sales Office

Dallas, TX
Tel: 214-536-9690
Fax: 972-866-9160

www.camino-modular-systems.com

Camino access floors have been installed for many of the worlds leading companies, including:

A.C. Nielson
Air Canada
Allstate Insurance
Amdahl
AT&T
Bank of Moscow
Bank of Montreal
Bank of Nova Scotia
Banko Sandander
Bell Telephone
Cantel
Charles Schwabb
Chase Manhattan Bank
Chrysler
CIBC
Citicorp Bank
Clearnet
Coca Cola LTD
Credit Suisse
Dai Ichi Bank
Deacon Barclays Bank
Dean Witter

Department of Defense
Discovery Museum
Dow Chemical
Exxon
Ford Motor Company
FUJI
General Motors
Hewlett Packard
Hydro Quebec
IBM
Kenya International Airport
Labatt's Brewery
Loblaws Head Office
MacMillan Bloedel
Mayo Clinic
McDonnell Douglas
MCI
Microsoft's Head Office
Ministry of Finance
Ministry of Transportation
Molson's Brewery
Morgan Guaranty Trust

Motorola
Ontario Hydro
Oracle Corporation
Pacific Bell
Pitney Bowes
Public Works Canada
RCMP
Rockwell International
Rogers Communications
RBC Royal Bank
Shell Oil
Société Immobiliere du Quebec
Société Générale
Sprint
Teleglobe
TD Bank
United Airlines
U.S. Air Force
U.S. Navy
Volkswagen
Union Bank of Switzerland

LP SERIES

LOW PROFILE ACCESS FLOOR SYSTEM



LP Series

Low Profile Access Floor System
Camino Flex Modular Wiring System

- Lower operating costs
- Increase productivity - less downtime
- Faster move-in
- Improve workplace aesthetics
- Technology flexible now...and in the future

Reduce Construction Fit Up Costs*
Faster Construction Schedule

*Capital cost comparison study customized to your project requirements available upon request

Furniture re-location without access flooring. \$1250.00*per station
Furniture re-location with access flooring and modular wiring. \$108.00 per station
Savings per workstation change. \$1142.00 per station

*Source IFMA

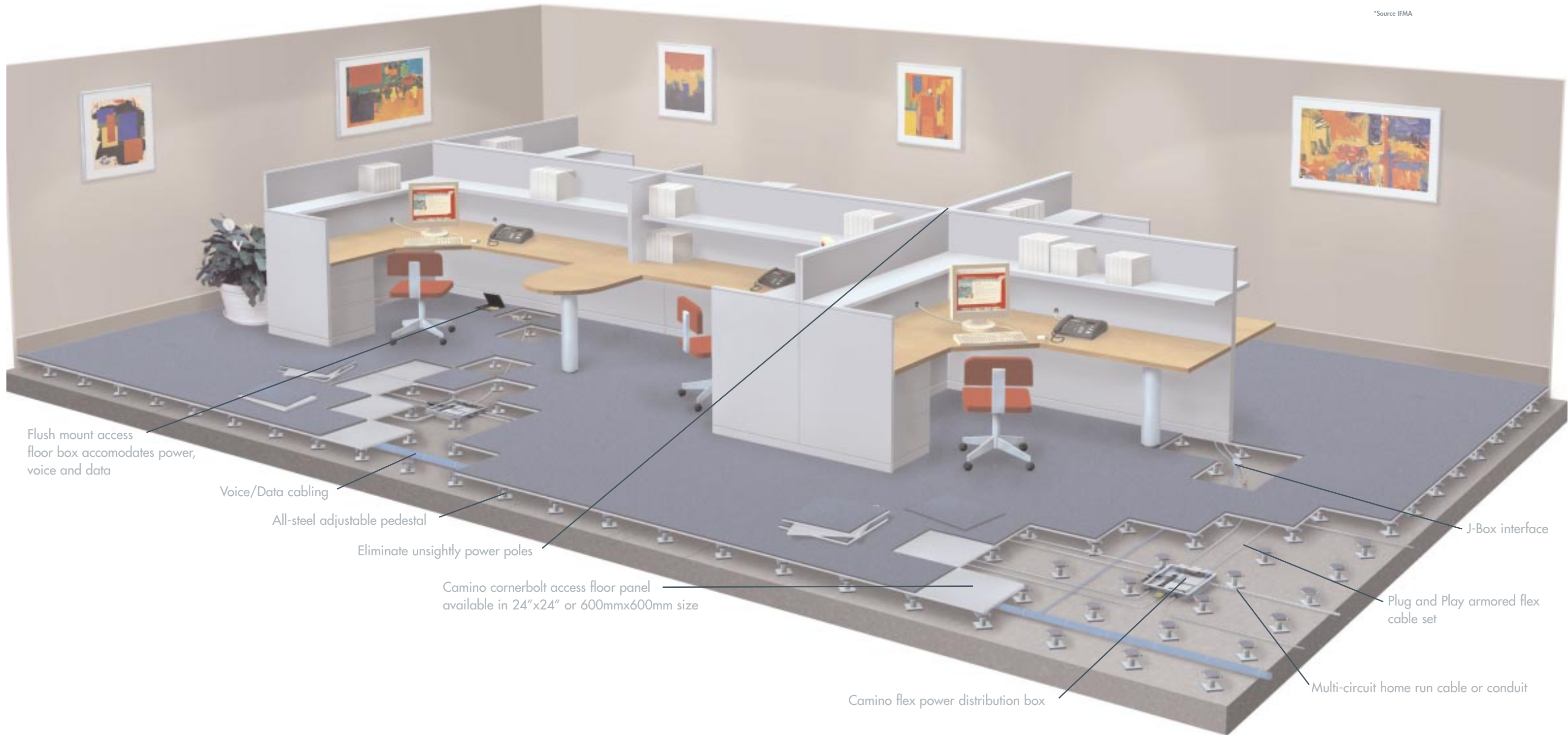



Space Planning Flexibility

Lower Operating Costs



Unlimited Choice of Floor Heights

- exceptional load performance and slab like acoustics

SPEC INFO 1-800-370-0226

12" - 24"
Finished Floor Height



8" - 12"
Finished Floor Height



4" - 6"
Finished Floor Height



3"
Finished Floor Height

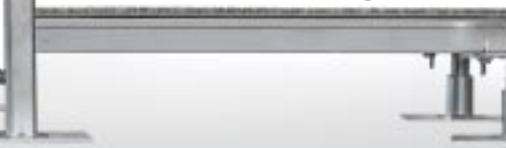

2 1/2"
Finished Floor Height

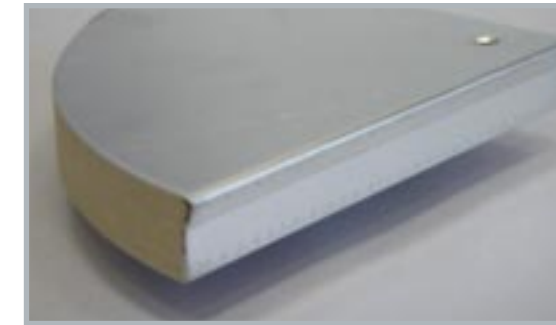

SC1000 Standard Duty (1000lbs./sq.in.)
SC1300 Medium Duty (1300 lbs./sq.in.)
SC1500 Heavy Duty (1500 lbs./sq.in.)



COMPUTER ROOMS/DATA CENTERS



UNDERFLOOR AIR OPTION

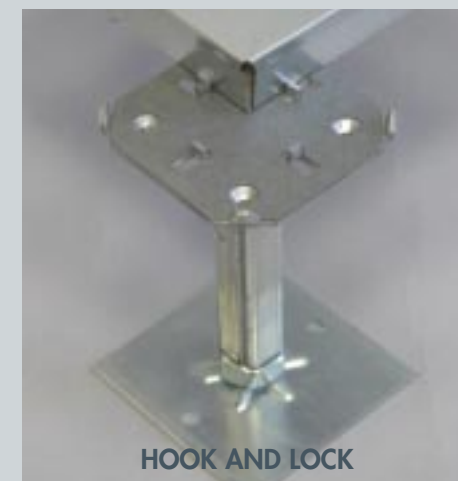

HOOK AND LOCK

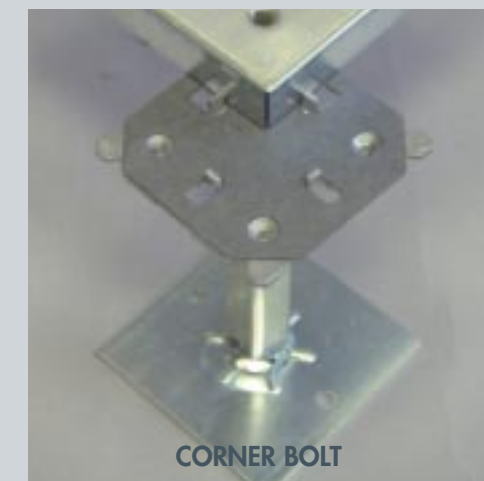

CORNER BOLT

Camino Flex Plug and Play Modular Wiring

Service, Support and Reliability

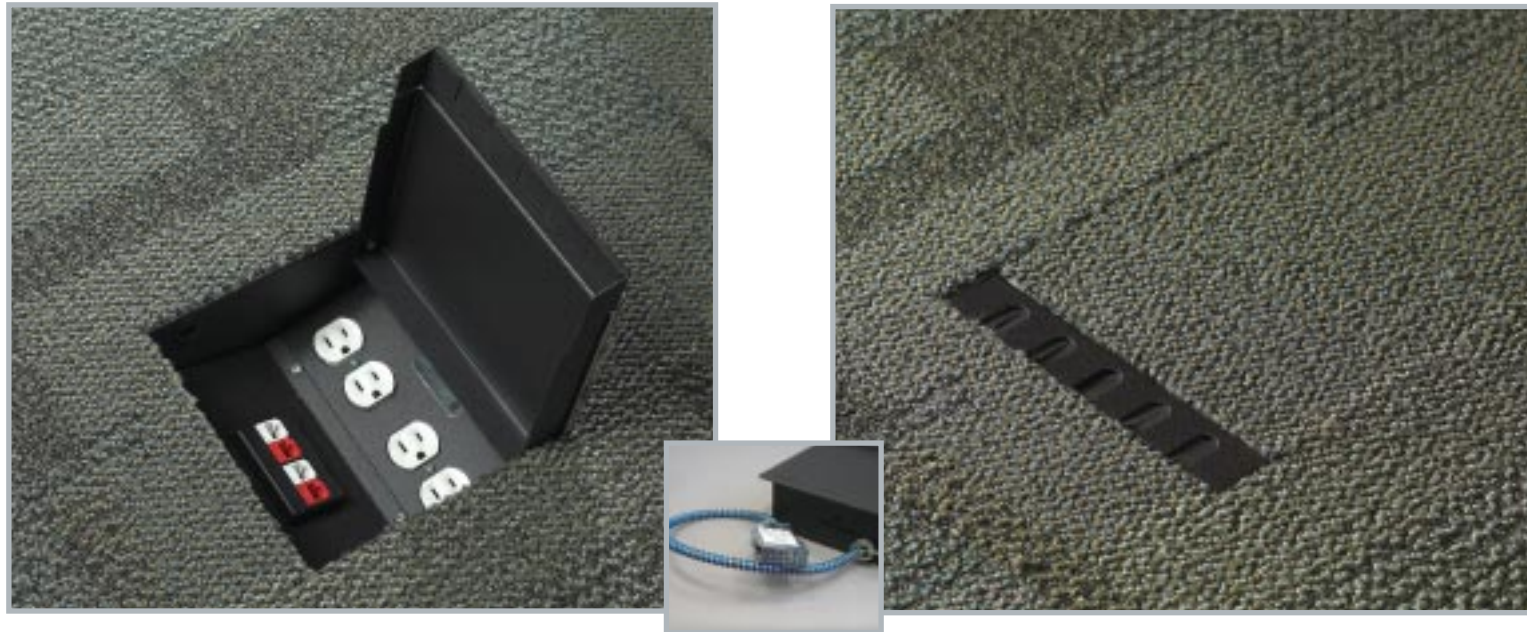

All boxes available in IG and dedicated power configurations



Voice/data plates accommodate all manufacturer's connectors

- Manufacturer of access flooring and electrical products since 1970.
 - In-house electrical, mechanical and structural engineers.
 - In-house CAD department provides detailed shop drawings.
 - Installation services and site supervision available.

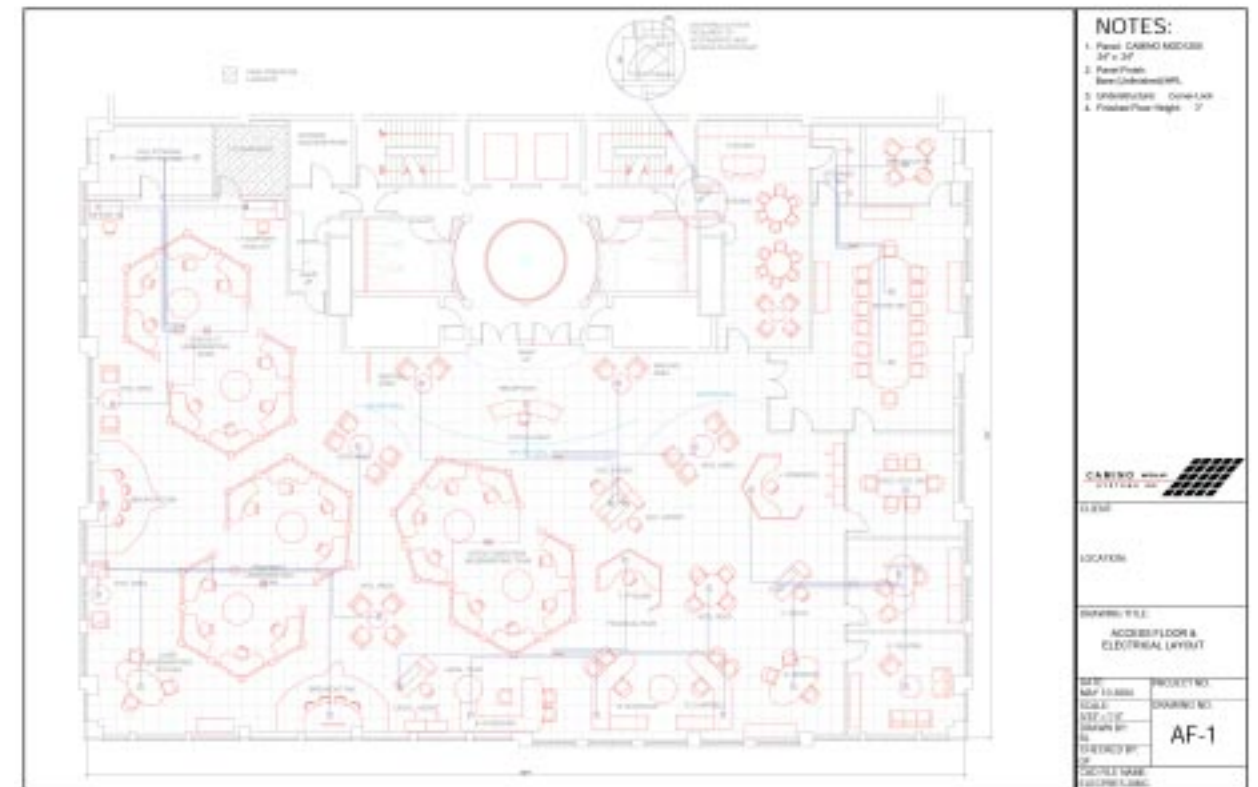

Camino flex plug and play wiring systems are compatible with all types of furniture systems

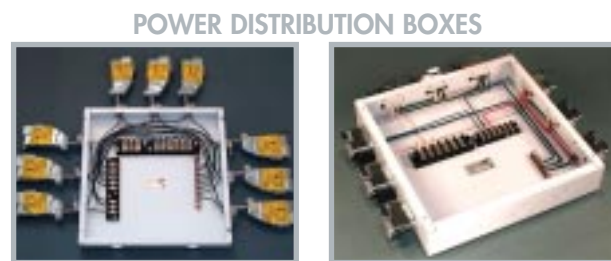

Low profile design fits in 2 1/2" FFH floor system. Available in 4, 6, 9, or 12 port configurations. Factory pre-wired to suit project circuiting requirement.



Standard design available in 4, 6, 9, and 12 port configurations. Power out ports are labeled to ensure organized electrical installation.

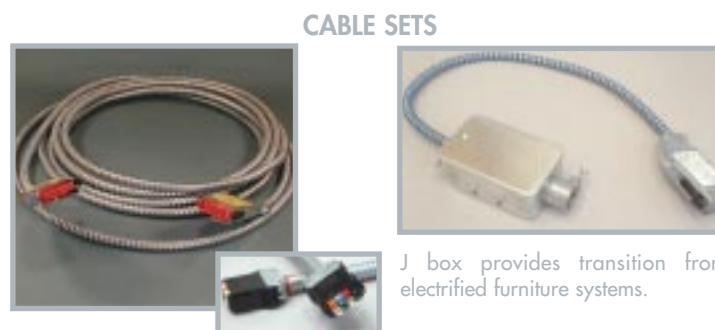

Plug and play cable sets available in 3 to 10 wire configurations and lengths of 10 ft, 15 ft, 20 ft, 25 ft, 35 ft, 50 ft and 75 ft.

J box provides transition from electrified furniture systems.

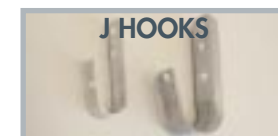

Cable Management Accessories

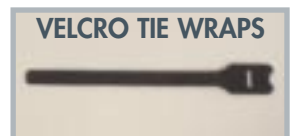

Superior Structural Integrity and Cabling Capacity

Camino adjustable all-steel pedestal and laser level installation techniques ensure a flat, solid floor system.
24" (600mm) pedestal spacing provides up to 80% more cabling capacity.



Plastic Cone Type System - NO ADJUSTABILITY creates uneven floors and rocking panels.
Limited raceway space for cable installation.



Superior Underfloor Clearance (2 1/2" Finished Floor Height)

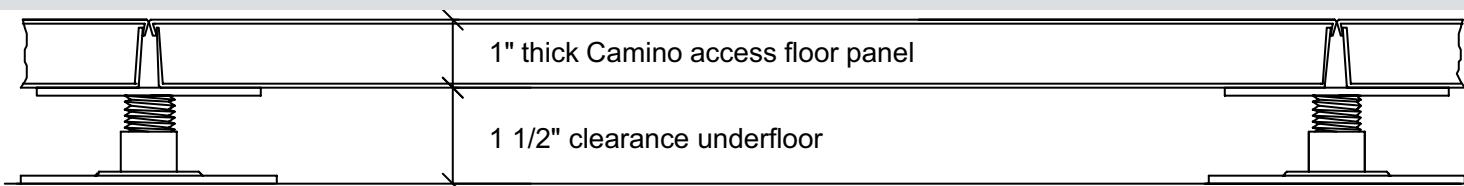

Camino provides up to 57% more clearance than competitive systems to accommodate pipe, crossovers and junction boxes.

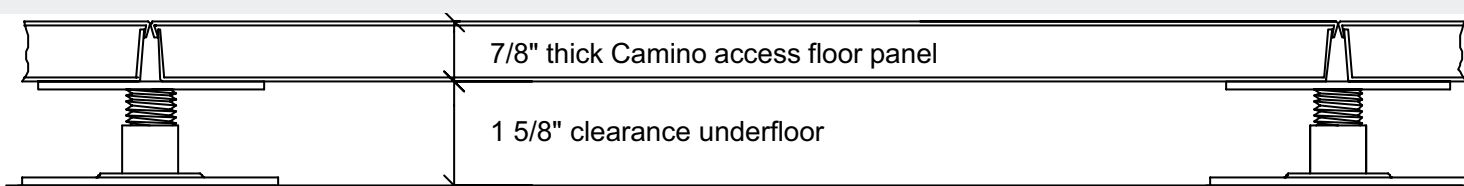

Designer Finishes

